

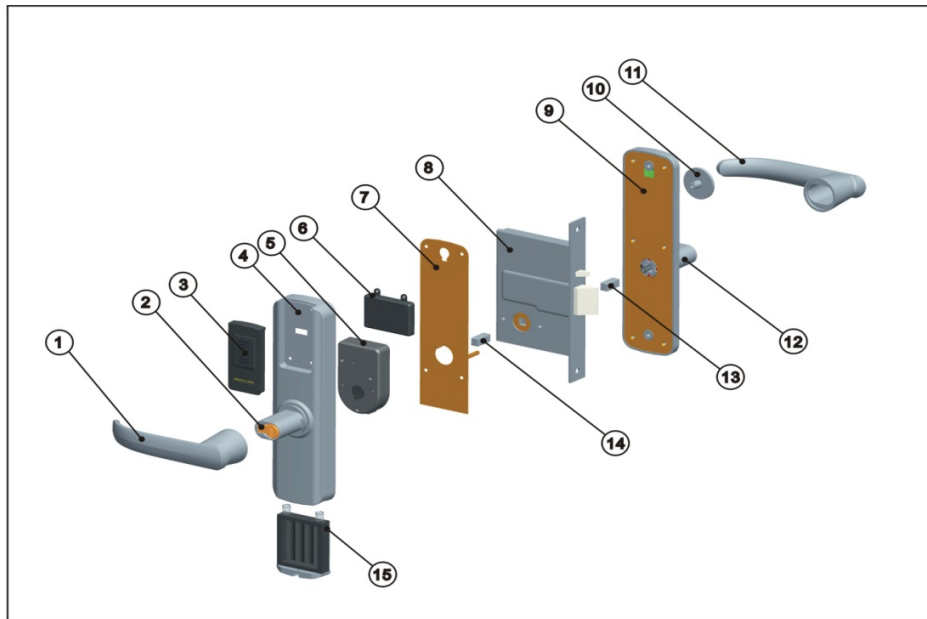

QLock Fitting Instruction

QLock Installation



Legend:

1. Front Lock Lever
2. Cylinder
3. Lock Reader
4. Lock Front body
5. Clutch Mechanism
6. Circuit Board assembly
7. Front Body Mounting Plate
8. Mortise/ Latch
9. Back Body Mounting Plate
10. Privacy Thumb Turn
11. Back Lock Lever
12. Inside of Back Lever
13. Rear Spindle (For Mortise lock only)
14. Front Spindle (For Mortise lock only) – Tubular latch lock has one long Spindle



Step 1: Cut the door as per below installation template

- Tubular latch installation template (70mm backset shown as example)

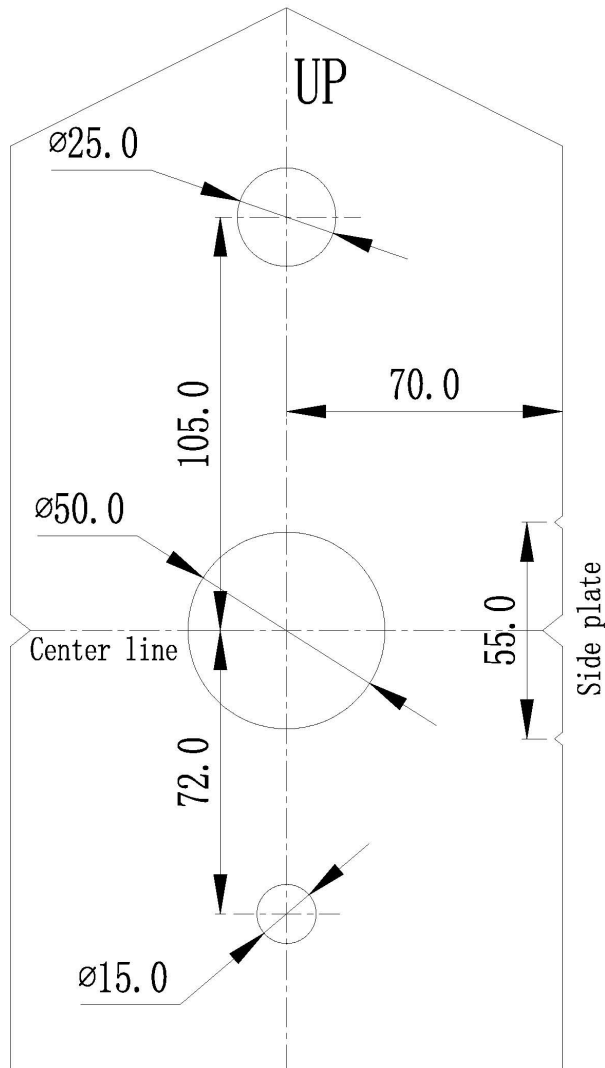

- Australian Mortise installation template



Step 3: Place the batteries inside the battery holder and screw the battery holder in – **Make sure the “Positive” and “Negative” for each battery is correctly in place.**

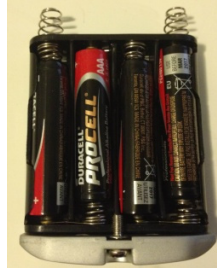

Step 4: Place the Levers on Front body and Back body then fasten the grub screws

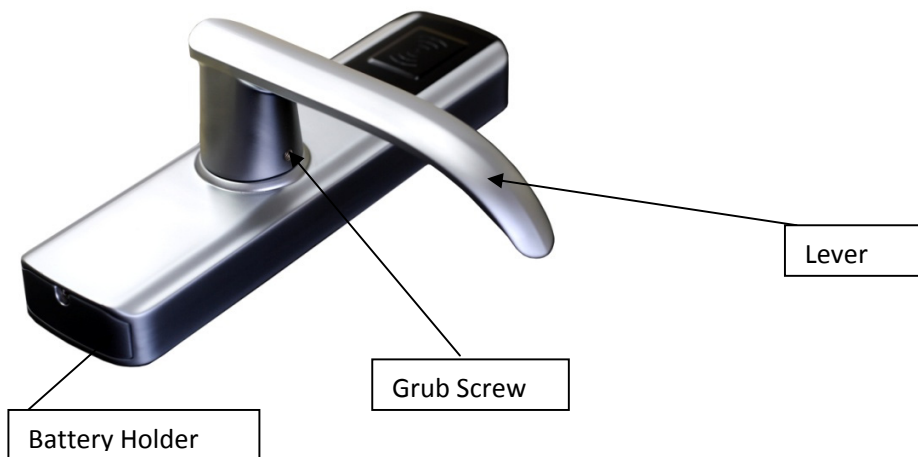



Step 5: Place the Spindle into the hole at the back of Front body then through the spindle hole on the latch or mortise- **Make sure the “Triangle “ sing is facing up as shown here:**



Wrong

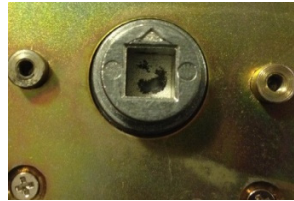

✓ Correct

Step 6: Connect the Privacy cables between Front body and Back body

Step 7: Place the Front and Back lock bodies on the door and fasten the Main screws between Front body and Back body

